

*Led medium intensity dual color flashhead LS140 type - Compliant with medium intensity type A during the day - Compliant with Feuer W, rot during the night - Verified by the Ministry of transportation in Germany for Medium intensity type A during the day and Feuer W, rot during the night*



Flashhead

- 6 led projectors 113761HG coming with connector
- junction box 113748H
- Approved by Ministry of Transportation in Germany

To be used with power supply P/N113733D for 1 light or P/N113734 for 2 lights with battery back-up

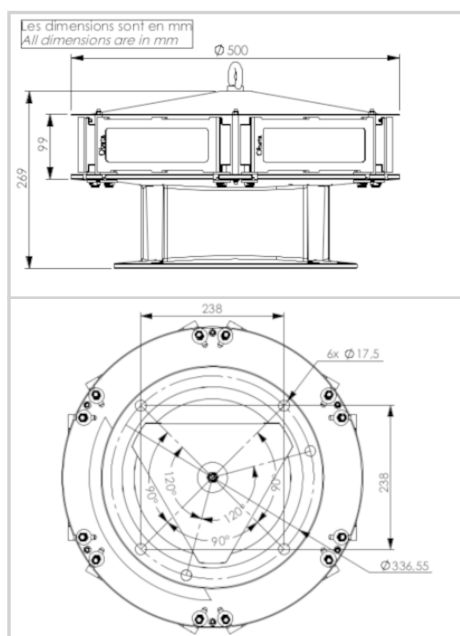

Mechanical Characteristics	
Operating temperature	-40/+55°C
Weight	5 kg
Size of the light	333mm (height) x 500mm (diameter)
Weight	14kg
Attachment	6 mounting holes dia.16mm, dia.337mm circle (FAA standard)
Photometric Characteristics	
Effective light output day time at 0° on site	20 000cd (white)
Effective light output twilight mode at 0° on site	20 000cd (white)
Effective light output night mode at 0° on site	200cd (red morse)
Color day/twilight time	white
Color night time	Red
Vertical beam spread	>3° in white, feuer W rot in red
Horizontal beam spread	360°
Standards	
Standards compliance	ICAO medium intensity type A during the day and Feuer W, rot during the night
Certification	LS140 Medium intensity type A + Feuer W, rot