

Calibrated ambient sensor (photo cell) for twilight-night intensity change in accordance with ICAO and FAA for all OBSTA lights or for the change of color and light-intensity



- ✦ plug-in modular construction with plated contact surfaces
- ✦ possibility to rotate the sensor on its base
- ✦ automatic control of the red or dual obstruction lighting according to ambient light in compliance with FAA and ICAO twilight/night triggering level (2 output signals available for night and twilight)
- ✦ timer to prevent the functioning of the cell at inopportune times (lightning)

One junction box NAV-JB-8 and the bracket PHOTOCELL-HOLDER are included in this kit

Les dimensions sont en mm  
All dimensions are in mm

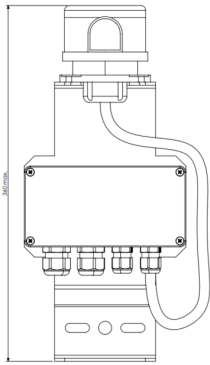
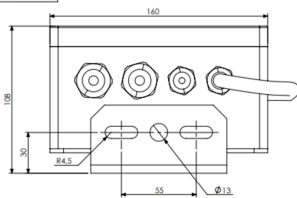

### Electrical Characteristics

Main voltage	110VAC to 240VAC +/-10% 50/60Hz
Average wattage	1.5VA
Max. admissible current	2A contact closed for the night mode and 0,3A for the twilight mode

### Mechanical Characteristics

Cable diameter	Ø11mm
IP degree	IP65 in vertical position
Wiring	On stripped wires
Operating temperature	-35°C/+60°C
Weight	1,3kg
Attachment	vertical bracket

### Standards

Standards compliance	ICAO annex 14 chapter 6, FAA (AC 150/5345-43J), UK MOD, Transport Canada
----------------------	--