

Support for one photocell and a derivation box P/N 113946

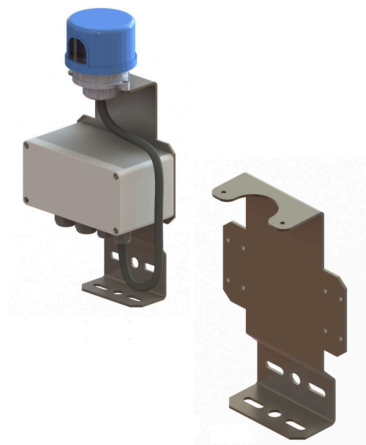

- Stainless bracket with a thickness of 3mm
- This bracket allows to fix a photocell on a vertical or horizontal support with a junction box NAV-JB-8

Tous dimensions sont en mm  
All dimensions are in mm

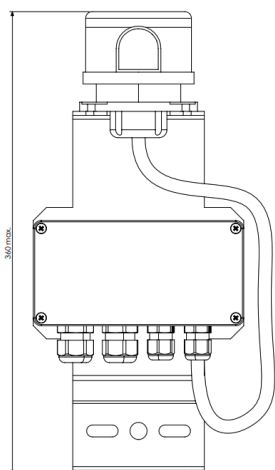
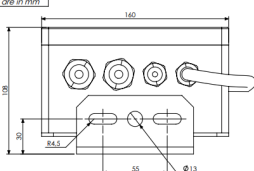

### Mechanical Characteristics

Weight	0.77 Kg
Attachment	2 mounting holes for M8 screws

