

Calibrated ambient sensor (photocell) for twilight-night intensity change in accordance with ICAO and FAA for all OBSTA lights or for the change of color and light-intensity

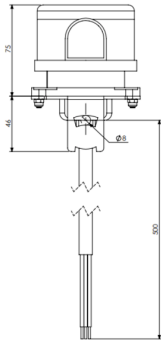

- ✦ plug-in modular construction with plated contact surfaces
- ✦ possibility to rotate the sensor on its base
- ✦ automatic control of the red or dual obstruction lighting according to ambient light in compliance with FAA and ICAO twilight/night triggering level (2 output signals available for night and twilight)
- ✦ timer to prevent the functioning of the cell at inopportune times (lightning)
- ✦ this photocell is provided with a bracket to fix it on a wall and 40cm of molded cable

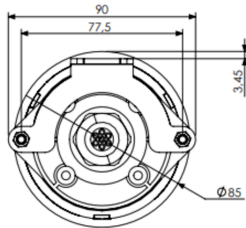

Electrical Characteristics

Main voltage	12VDC to 48VDC -10%/+15%
Average wattage	1.5VA
Max. admissible current	2A contact closed for the night mode and 0,3A for the twilight mode

Mechanical Characteristics

Cable diameter	Ø11mm
IP degree	IP65 in vertical position
Wiring	On stripped wires
Operating temperature	-35°C/+60°C
Weight	0.42 kg
Weight	300g
Attachment	vertical bracket

Standards

Standards compliance	ICAO annex 14 chapter 6, FAA (AC 150/5345-43J), UK MOD, Transport Canada
----------------------	--