

## Controler for high intensity led lights

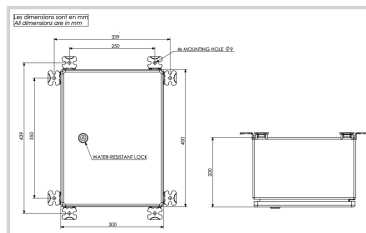

- stainless cabinet
- cable inputs by gland nickel plated brass
- up to 32 high intensity lights OFH series with one unique luminous indicator per light with a 5G control cable
- surge protection
- connexion of the photocell and the control cable
- remote/manual switch to bypass the photocell and force day/twilight/night mode



Electrical Characteristics	
Main voltage	110VAC to 240VAC +/-10% 50/60Hz
Mechanical Characteristics	
IP degree	IP65 in vertical position
Weight	3,5kg
Weight	3,5kg
Size of the power supply	315mm (height) x 210mm (width) x 110mm (dept)
Cable entry diameter	from 8 to 15 mm
Wire cross section	from 1 to 4 mm <sup>2</sup>
Attachment	4 screws type M5